



* Second Microphone is not available on all models.

ATTENTION DO YOU NEED HELP?

Please do not return this product to the store.

If you need installation assistance, replacement parts, or have questions regarding our warranty, please contact our customer care center:

Info@focusear.com

FOCUSEAR™
PERSONAL SOUND AMPLIFIER

PSAP VS HEARING AIDS

“While some of the technology and function of hearing aids and Personal Sound Amplifier Products may be similar,” our goal is to provide amplifiers for recreational, social, and business use which are the best ear level electronics in the marketplace.

FocusEar products are simple to use, comfortable, inconspicuous and easy to wear and maintain. Looking for a better listening experience or need help with competing noise environments? FocusEar turns ordinary hearing into extraordinary hearing and will benefit most people looking to understand conversations in noisy environments. FocusEar allows you to hear speech and other normal sounds with more clarity.

WHEN YOU WANT A BOOST

FocusEar allows you to enhance your listening skills. The highest fidelity available in ear worn devices is here. They will amaze you in noisy situations and will improve your ability to focus on the important sounds you want to hear.

We are constantly improving our products and are most interested in your opinion on how to improve our technology. We will not rest our ears, until the whole world hears!



WWW.FOCUSEAR.COM

INSTRUCTION GUIDE



CLEANING & CHANGING TUBES

Use a soft cloth to wipe your FocusEar after use to remove any particles or moisture. The Cleaning Tool is used to remove debris / wax from the sound tubing and earbud.

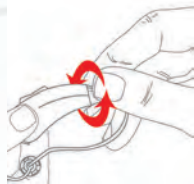

1. To remove tubes gently rotate the sound tubing holding the instrument firmly.



2. Pull sound tubing from the the FocusEar device.

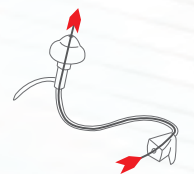

3. To clean, insert the cleaning tool through the nose cone end. Thread all the way through the tubing & earbud.



4. To reassemble or change sound tubing simply line up and push tubing onto brass coupler until it snaps into place.

POWERING YOUR FOCUSEAR

FocusEar uses a 312 Battery.

TO TURN ON - With your finger, gently open the door. Insert battery and close the door. Your FocusEar is equipped with a power on delay, so you will be given several seconds to seat the device comfortably in your ear before it turns on. When placing the battery in your FocusEar device, position the battery with the positive (+) side (or totally flat side) up and insert it into the battery compartment. If the battery is inserted correctly, the door will close easily.

Do not force the door closed.

NOTE: Your FocusEar device will beep twice when your battery is running low.

CAUTION: Batteries are dangerous if swallowed! Keep batteries out of the reach of children. Never put batteries in your mouth for any reason - they are easily swallowed. In the event a battery has been swallowed, seek immediate medical attention.

TO TURN OFF - To remove the device simply grasp the tubing close to the earbud or earmold and remove from ear canal. Then remove instrument from the top of the ear.

To turn your FocusEar off, simply open the battery door completely. Store in a safe dry place.

INSERTING YOUR FOCUSEAR

Before insertion, please clean your ear and make sure the battery door is closed properly. Follow the procedure for inserting your FocusEar device listed below:



Fig. A

- Hold the tubing with your thumb and index finger close to the ear dome and Place the instrument over the top of the ear. (Fig. A)

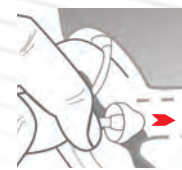

Fig. B

- Gently insert the ear dome into your ear canal. (Fig. B)



Fig. C

- Move the retention lock into position by lifting and placing it into the bowl of your ear. (Fig. C)

NOTE: Some irritation may occur due to becoming accustomed to wearing a new hearing instrument. If swelling or redness occurs, discontinue use and visit your Doctor.

VOLUME ADJUSTMENT

The rocker switch is both a volume control and multi-mode control. The default is volume control and operates as described below:

For all adjustments place thumb into the helix portion of your ear. Next, take your index finger and place it on the rocker switch. (Fig. 1)

Briefly push/release the top half of the switch to increase volume (Fig. 2) and bottom half of switch to decrease the volume (Fig. 3). Each short press changes the volume slightly.

Fig. 1

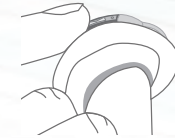

Fig. 2



Fig. 3



MODE ADJUSTMENT

If your device is equipped with multiple modes, your FocusEar will start in mode one. To change modes, hold down the top half of the rocker switch for 3 seconds (Fig. 2). The number of beeps correspond to the program. The programs will cycle up in sequence 1,2,3,1,2,3 etc....

Find the program that is most comfortable for you and meets the need of the environment that you are in.